

notes  
 this drawing and design is the copyright of aja architects llp and must not be reproduced in part or in whole without prior written consent; contractors must verify all dimensions on site before commencing work or preparing shop drawings if in doubt ASK.  
 Where this drawing contains any Ordnance Survey mapping material, it has been reproduced under license number 10032275.  
 Ordnance Survey © Crown copyright 2020

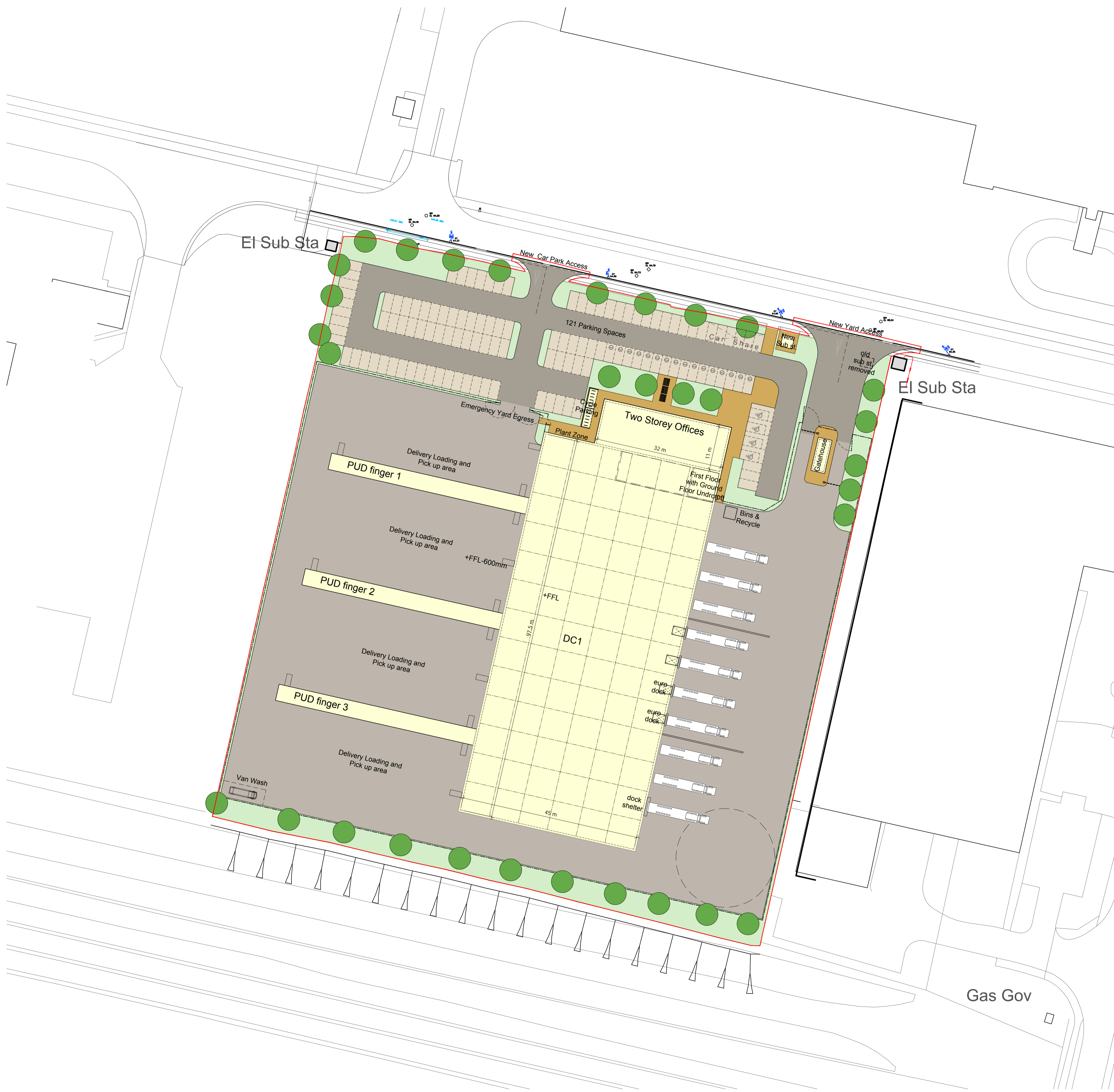
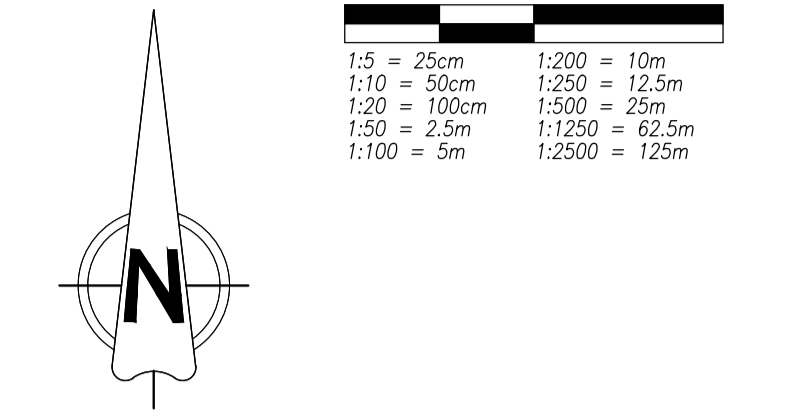

**Schedule of Areas**  
 (All areas are gross internal)

|                     |                            |                      |
|---------------------|----------------------------|----------------------|
| Clear haunch height | 12m                        |                      |
| Warehouse           | 4,388 m <sup>2</sup>       | 47,230 sq.ft.        |
| GF Office           | 356 m <sup>2</sup>         | 3,842 sq.ft.         |
| FF Office           | 356 m <sup>2</sup>         | 3,842 sq.ft.         |
| FF Mezz             | 51 m <sup>2</sup>          | 549 sq.ft.           |
| PUD Finger 1        | 204 m <sup>2</sup>         | 2,195 sq.ft.         |
| PUD Finger 2        | 204 m <sup>2</sup>         | 2,195 sq.ft.         |
| PUD Finger 3        | 204 m <sup>2</sup>         | 2,195 sq.ft.         |
| Gatehouse           | 22 m <sup>2</sup>          | 236 sq.ft.           |
| <b>TOTAL</b>        | <b>5,785 m<sup>2</sup></b> | <b>62,284 sq.ft.</b> |
| GEA                 |                            |                      |
| Ground Floor        | 5,586 m <sup>2</sup>       | 60,127 sq.ft.        |
| First Floor         | 433 m <sup>2</sup>         | 4,660 sq.ft.         |
| <b>TOTAL</b>        | <b>6,019 m<sup>2</sup></b> | <b>64,787 sq.ft.</b> |

|                       |            |            |
|-----------------------|------------|------------|
| Car Parking           | 121 spaces |            |
| Site Area to red line | 2.18 ha.   | 5.39 acres |

|     |          |  |     |
|-----|----------|--|-----|
| E   | 24.11.21 | fp / cycle connection to site widened, car share added       | ans |
| D   | 15.11.21 | redline updated to include road crossings and areas adjusted | ans |
| C   | 04.11.21 | vehicle graphics updated, additional text added              | ans |
| B   | 04.11.21 | vehicle graphics updated                                     | ans |
| A   | 29.10.21 | initial issue.   | ans |
| no. | date     | revision   | by  |



aja architects llp  
 1170 Elliott Court  
 Herald Avenue  
 Coventry Business Park  
 COVENTRY CV5 6UB  
 E: aja@aja-architects.com  
 W: www.aja-architects.com  
 T: 024 7625 3200  
 F: 024 7625 3210

AJA Architects is the trading style of AJA Architects Consulting limited to limited company no. 10892795 and AJA Architects LLP (a limited liability partnership registered in England no. OC352721).



project  
**Proposed Development**  
**Plot 11e**  
**Hortonwood**  
**Telford**  
 drawing

Site Plan - Proposed  
**PLANNING**

|         |            |       |              |
|---------|------------|-------|--------------|
| scale   | 1:500 @ A1 | drawn | ans          |
| checked | ajps       | date  | October 2021 |

no.  
**6824 - 052 E**